

# Response to a Violent Intruder

**A**lert   **L**ockdown   **I**nform   **C**ounter   **E**vacuate

<https://www.youtube.com/watch?v=5VcSwejU2D0>

# **ALICE is based on premise that information, authorization, and proactive training are the key to surviving the Active Shooter.**

- ❑ **Alert:** all are authorized to announce, no codes are used
- ❑ **Lockdown:** must include barricade training
- ❑ **Inform:** use technology to provide play-by-play information
- ❑ **Counter:** interrupt the skill set needed to shoot accurately
- ❑ **Evacuate:** get away from danger if possible

# *Passive vs. Proactive Response Strategies*

## **Why is Preparation in Proactive Response Necessary?**

- 25 years of *mass shooting* events have yielded a national average for the response time of Law Enforcement to an Active Killer scene.
- How long:

# Why is Preparation in Proactive Response Necessary?

- 25 years of *mass shooting* events have yielded a national average for the response time of Law Enforcement to an Active Killer scene.
- How long:

**5-6 Minutes**

# RESPONSE TIME

What was the “**worst**” active shooter case in America, based on “body count”?

**Virginia Tech**

**In an active shooter scenario  
EVERY SECOND COUNTS**

# RESPONSE TIME

**Average** Active Shooter event lasts **4-8 minutes**

**Average** Law Enforcement response time is **5-6 minutes**, from when 911 is called.

## ***Virginia Tech :***

- *had the fastest response time ever for an active shooter event.*
- *In 3 minutes 2 fully armed SWAT teams arrived, but could not get in building*
- *They were 800 yards away when shooting started.*
- *In **9 mins** shooter fired 170 rounds, killing 30*

# 14 Years of Passive Response Strategies

	<b>Columbine Library 1999</b>	<b>Virginia Tech 2007</b>	<b>Sandy Hook 2013</b>
<b>Number of Bad Guys</b>	<b>2</b>	<b>1</b>	<b>1</b>
<b>Minutes of Shooting</b>	<b>8.5</b>	<b>8</b>	<b>5</b>
<b>Numbers Present</b>	<b>56</b>	<b>Approx. 100</b>	<b>Approx. 50</b>
<b>Age of Victims</b>	<b>Minors</b>	<b>Adults</b>	<b>Minors and Adults</b>
<b>Casualty Percentage</b>	<b>About 50%</b>	<b>About 50%</b>	<b>About 50%</b>
<b>Number Wounded</b>	<b>12</b>	<b>17</b>	<b>2</b>
<b>Number Killed</b>	<b>10</b>	<b>30</b>	<b>26</b>



# Columbine High School

April 20, 1999 Columbine High School

- 12 students and one teacher killed
- 24 other students were wounded

What happened to the other 1,900 Students?

**They EVACUATED!**

Within the Columbine Library

- 12 of the 24 were injured in the Library
- 10 Of the 12 killed were in the Library
- There was a Emergency Exit a few feet away.

# Why did 54 students STAY for 5 minutes?

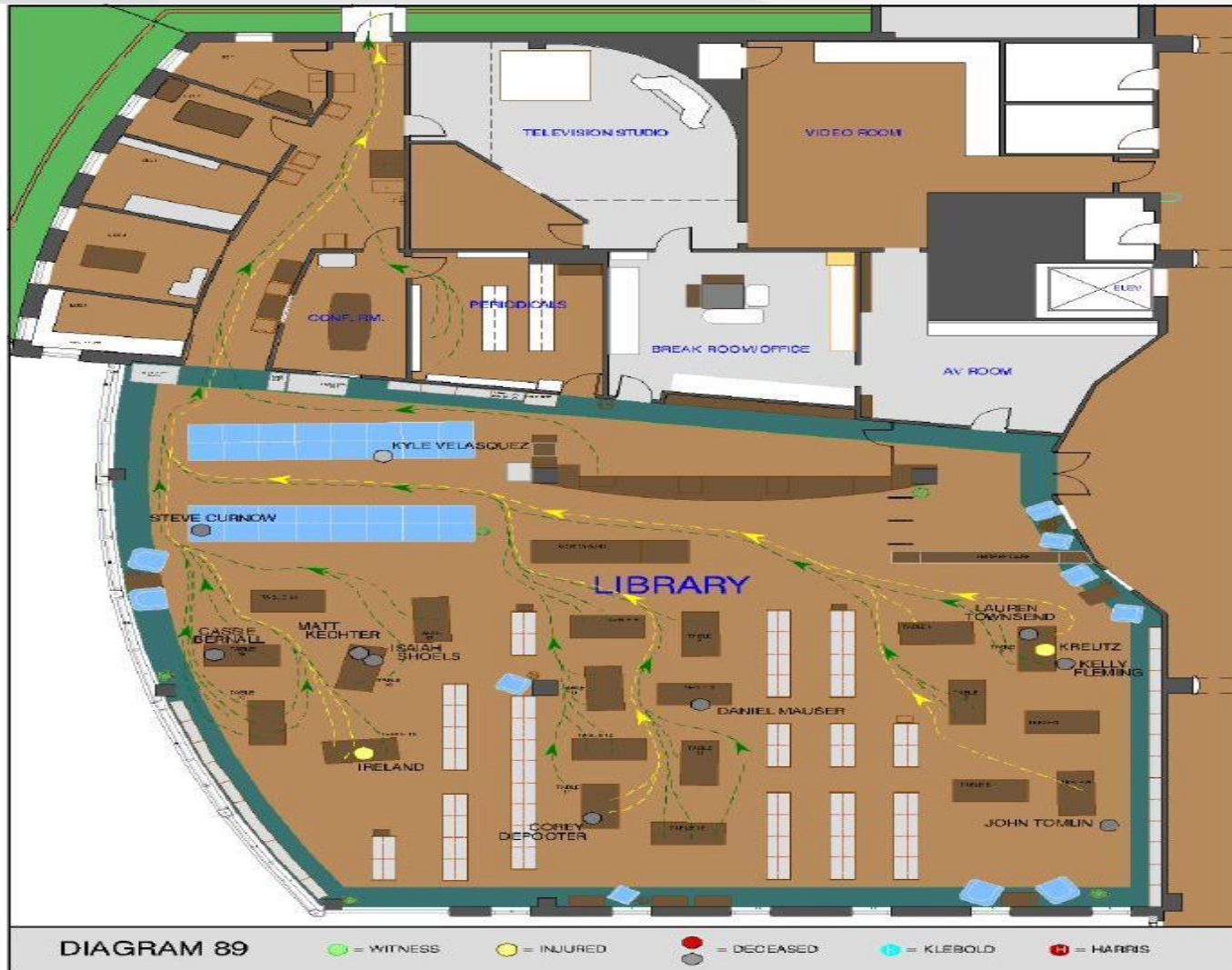

# Should they have STAYED?



# Why we need to know more:

## Attack Resolution

The NYPD organized attack resolution categories: applied force, no applied force

Table 2 shows that the vast majority of attacks were resolved violently, either by force applied by the police or by the attackers themselves. Only 1% of attacks resulted in a surrender.

If it is going to take an aggressive act to stop the killing, who do we hope is committing this act first?

*Table 2: Number of Incidents by Incident Resolution*

Resolution	Number of Incidents	Percentage
Applied Force	93	46%
No Applied Force	28	14%
Suicide/Attempted Suicide	80	40%
Attacker Fled	1	<1%
<b>Total</b>	<b>202</b>	<b>100%</b>

# Casualties by Category Since 1966

Note: Graph includes Beslan casualties

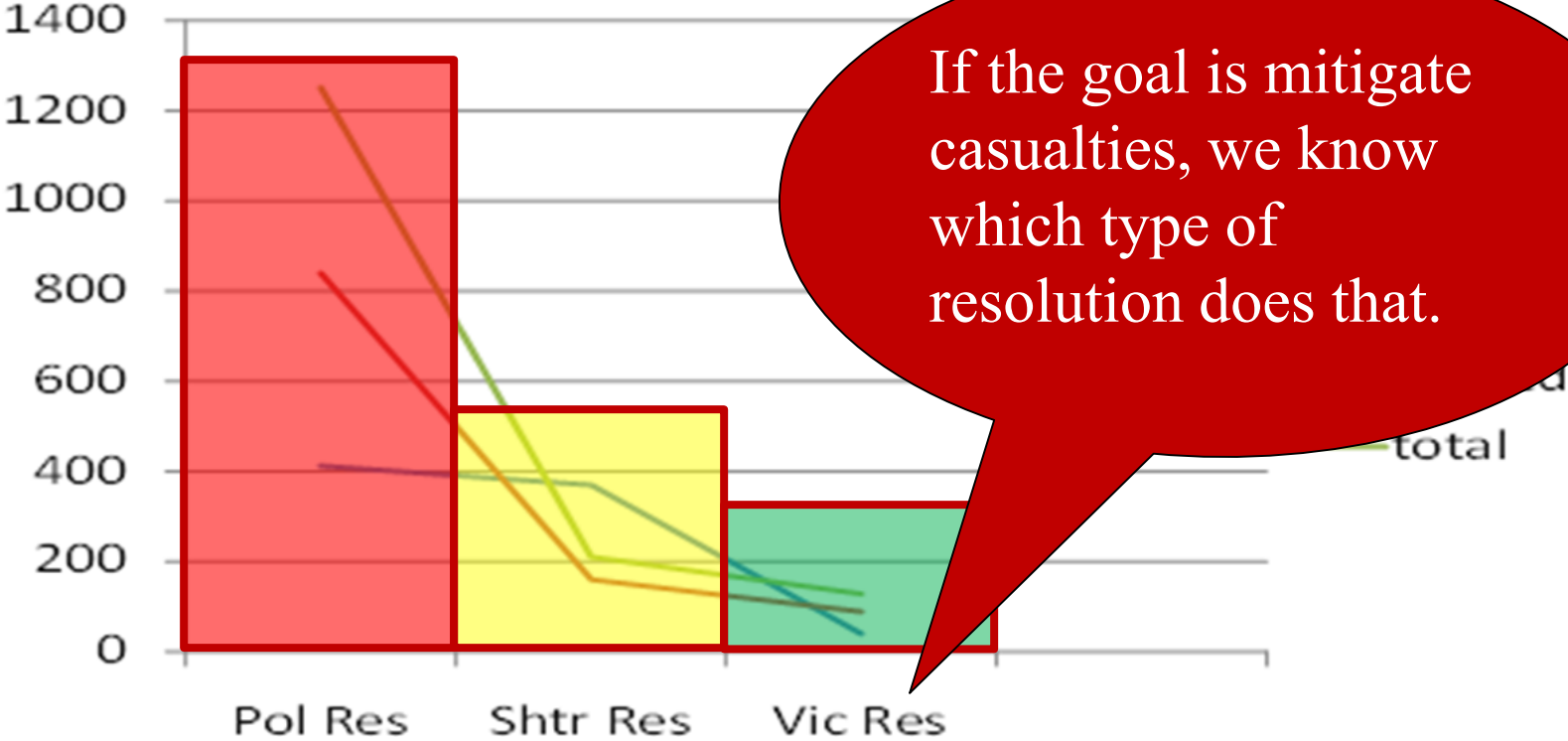

Courtesy of Bill Barchers, [www.hardtactics.com](http://www.hardtactics.com)

## WHAT DID WE LEARN FROM THE WAY THESE EVENTS ENDED?

- ☐ *Thurston High School, Springfield OR, 1998*
  - Courage or Reckless?
- ☐ *South Orangetown Middle School, NY, 2009*
- ☐ *Hillsdale HS, San Mateo CA, 2009*
- ☐ *University of Alabama-Huntsville, 2010*
- ☐ *Deer Creek Middle School, CO, 2010*
- ☐ *Snohomish HS, WA, 2011*
- ☐ *Chardon HS, Chardon OH, 2012*
- ☐ *2 x Baltimore Co MD schools, 2012*
- ☐ *Normal HS, IL, 2012*
- ☐ *All stopped by Educators or Students*

# There is now a movement towards Proactive Response at official levels:

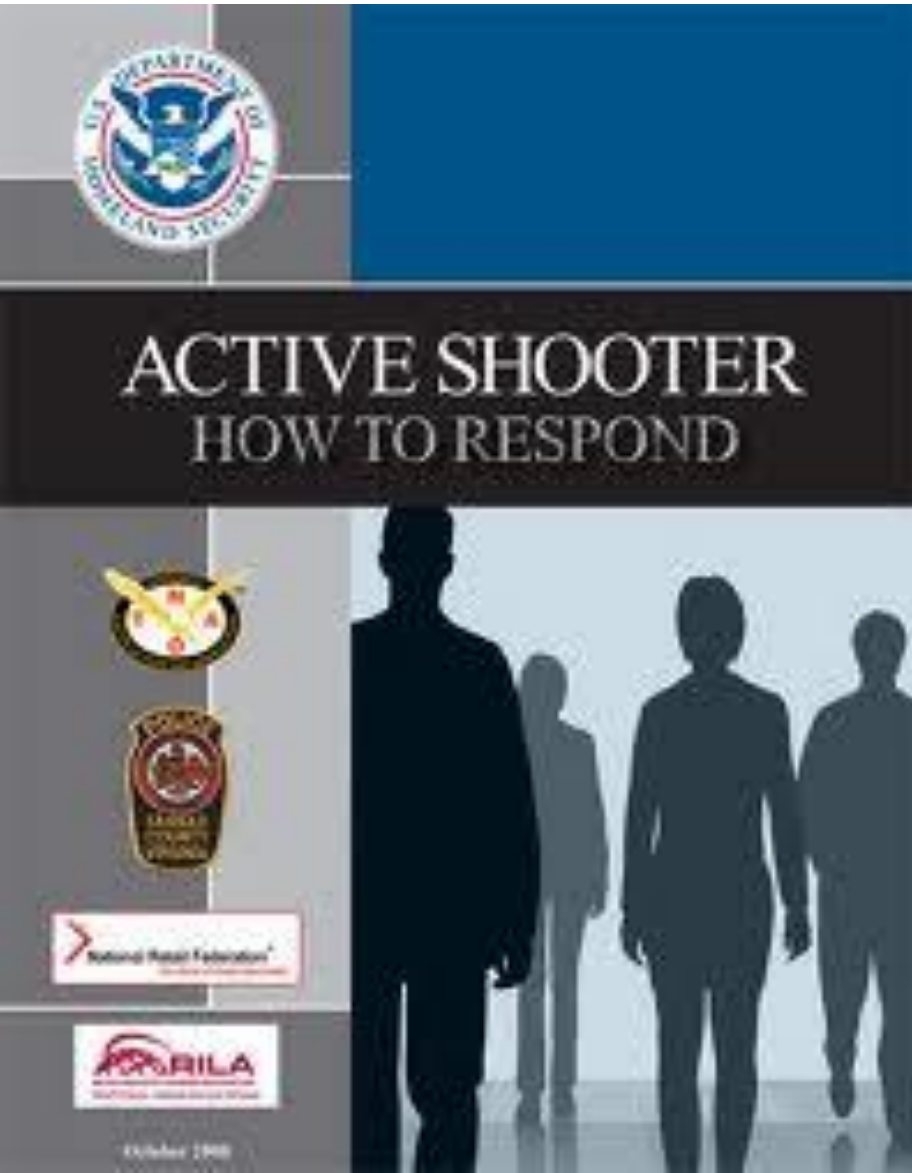

## DHS Recommendations

- October 2008
- Known as the 3-Outs Program
  - Get Out
  - Hide Out
  - Take Out

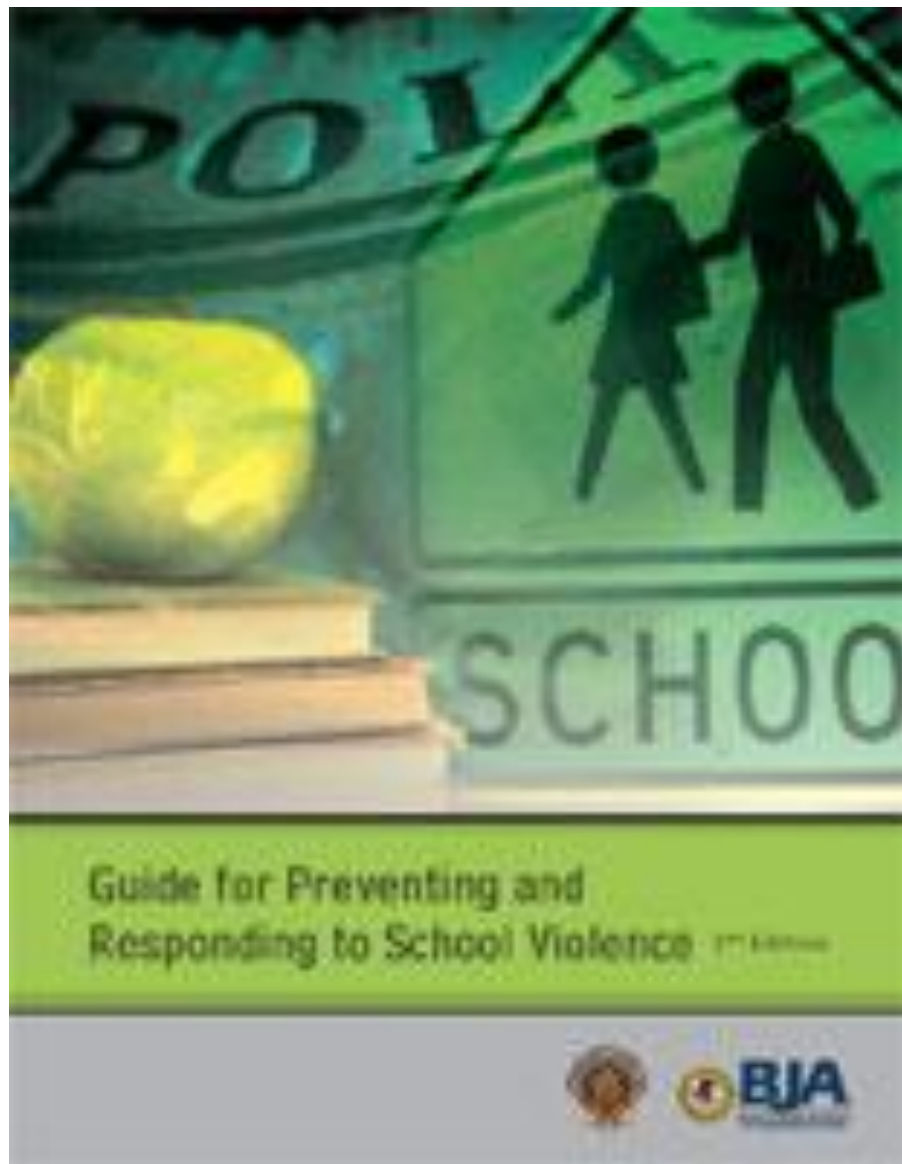

# IACP Recommendations

- October 2009
- Do not have a one-size fits all plan.
- Teachers choose to Evacuate or Lockdown
- Authorize decisions to be made
- Active Resistance is an option



# GUIDE FOR DEVELOPING HIGH-QUALITY SCHOOL EMERGENCY OPERATIONS PLANS



FEMA



# US Dept of Ed REMS Recommendations

- June 2013
- Has to be the end of LOCKDOWN only as the response plan for schools.

**OUR plans need to be in agreement with these recommendations**

**ALICE has led this movement since 2001.**

Traditional response is the  
defensive strategy of  
**LOCKDOWN.**

**STRONG PLACE TO START.**

**LOCKDOWN is a valuable  
option**, BUT as we have  
discovered it is not a one  
size fits all response.

First Floor

**UNDER THE LOCKDOWN CONCEPT,  
HOW MUCH OF THIS BUILDING IS  
CONSIDERED TO BE IN IMMEDIATE  
LETHAL DANGER?**



**LOCKDOWN!  
LOCKDOWN!**

# Any School, USA



**LOCKDOWN!  
LOCKDOWN!  
GUNMAN IN ADMIN  
HALLWAY!  
GUNMAN IN ADMIN  
HALLWAY**

TO THIS

The **A.L.i.C.E.** Program  
is not meant to change  
everything, but to  
**ENHANCE** current  
policy and give

**Options of Response**  
in various scenarios.

# Alert: Lockdown, Lockdown!!

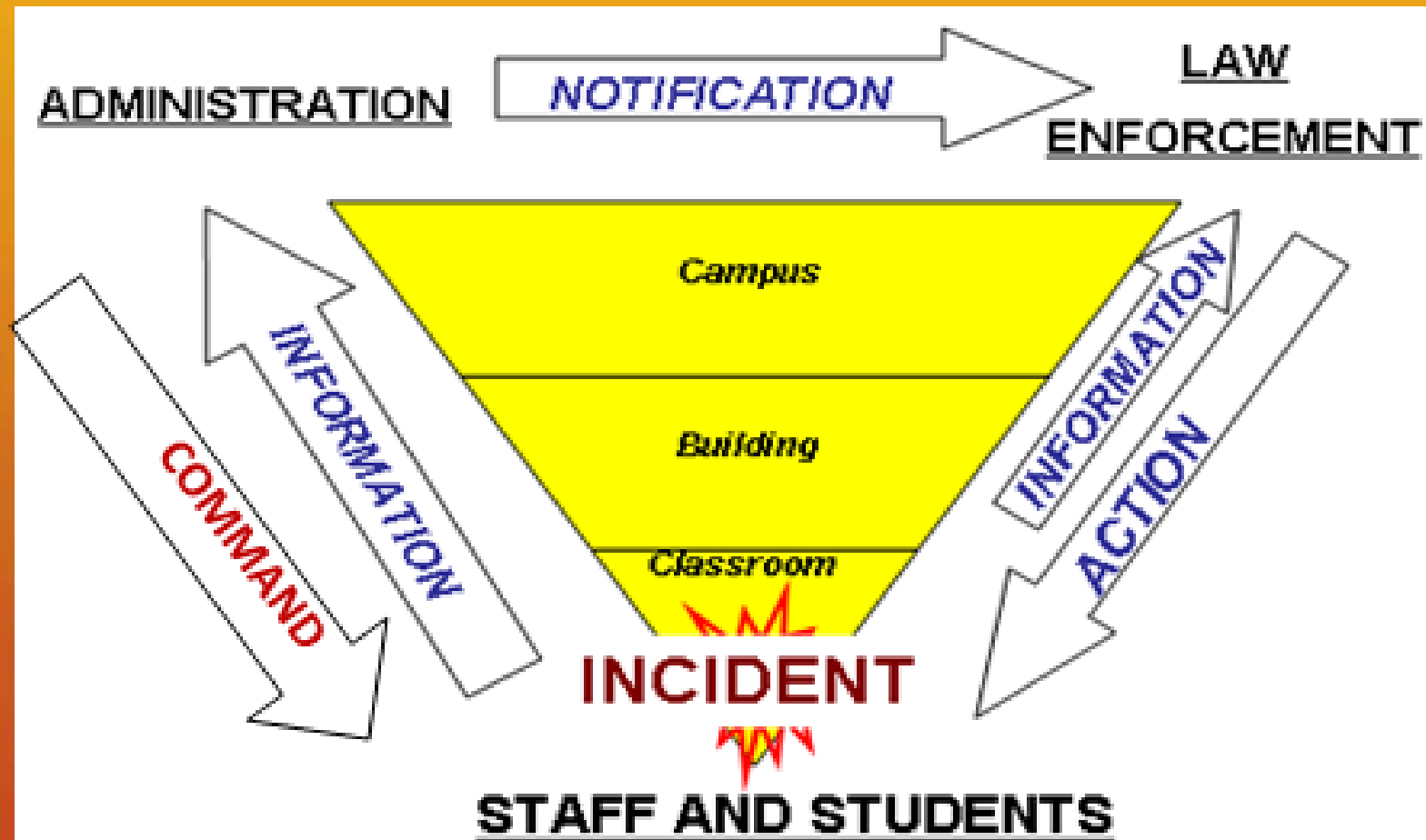

Easy, but is it Effective?

# Information Allows Options:

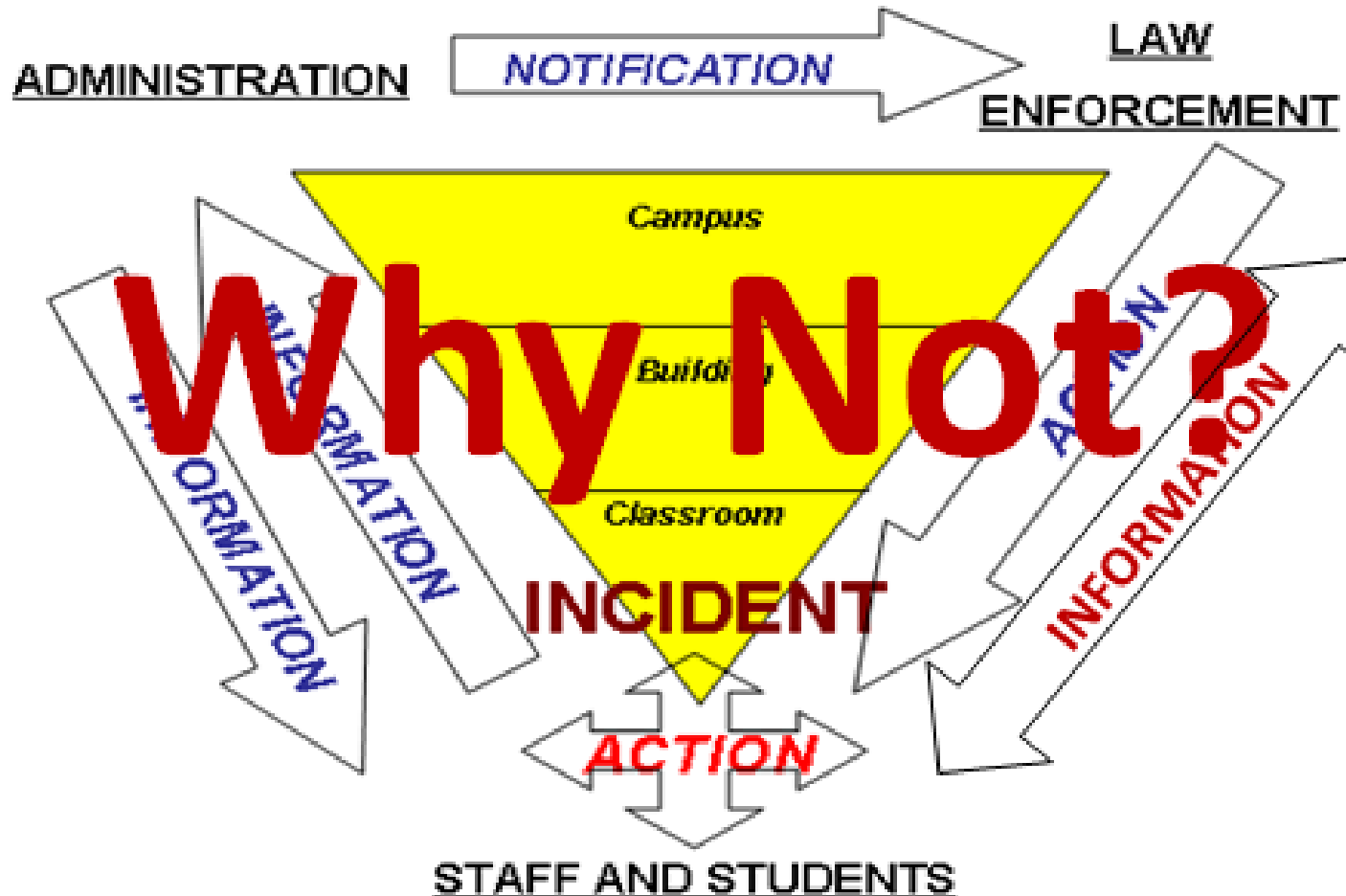

# THE Lesson from VT:

## 28 vs. 2 (Fatalities)

### Passive vs. Proactive

Room 210 No Class	<b>STAYED DOWN</b> Room 206 - 14 Present Killed - 10 Wounded - 2	<b>JUMPED</b> Room 204 - 19 Present Killed - 2 Wounded - 3	Room 200 No Class
Hallway - Killed 1			
Offices	<b>STAYED DOWN</b> Room 211 - 19 Present Killed - 12 Wounded - 6	<b>BARRICADED AFTER 1<sup>ST</sup> TIME</b> Room 207 - 13 Present Killed - 5 Wounded - 6	<b>BARRICADED</b> Room 205 - 12 Present Killed - 0 Wounded - 0

Data from Chapter 8, Virginia Governor's Report on Virginia Tech.



© 2012



# ALICE=Enhanced Lockdown!

A Comprehensive Program

*“Enhance ... Not Change!”*

Turn A.L. into A.L. .C.E.

*Alert*

*Lockdown*

 *nform*

*Counter, and/or*

*Evacuate*



© 2012

# Patty Nielsen 911 Audio



[dwi-productions.com/freevids](http://dwi-productions.com/freevids)

11:25.03

# OUR RESPONSE—**A.& L.**

- HEAR or SEE an intruder with a weapon
- Contact 911 by dialing 9 911 or 911
- Initiate **ALERT & LOCKDOWN** by using PA System— 77#111
- Contact Administration if possible
- \*These actions can/must be performed simultaneously by multiple persons (staff and/or students)

# OUR RESPONSE—I.

- Admin will **REISSUE** alert
- **INFORMATION** shall include all known info and be provided by all means possible—  
i.e “Shooter, in office..,Lockdown”
- Outside building—**GO** to school rally point
- Inside building, but outside of locked rooms—move opposite of activity, **GO** to school rally point (LMS)
- Admin will continue to **INFORM**

# OUR RESPONSE—**L. or E.**

**IF in a SECURABLE room--** decide to **LOCKDOWN** or **EVACUATE**. USE OPTIONS.

- If there is info to indicate ability to **EVACUATE**—RUN to school rally point
- If Evacuation not possible—**LOCKDOWN** (locks, lights, out of sight, BARRICADE)
- Gather **DISTRACTION** devices
- **DO NOT OPEN DOOR**

# OUR RESPONSE—C.

**Active shooter is in your room**—attempt to **COUNTER** if able, as an option, by:

- NOISE
- Create MOVEMENT, as much as possible
- THROWING items at face of shooter, DISTRACT, OODA Loop
- TAKE CONTROL of SHOOTER: SWARM—personal choice, **dependent on age of students**
- NEVER pick up weapon—cover with trash can and sit on

# Usual Concerns:

1. There could be more than one shooter.
2. They could run into the shooter if they evacuate.
3. How will we account for those who left?
4. Who will be liable?
5. Small children aren't capable. **"Stranger Danger"?**
6. Special Ed is not addressed.
7. Rally Point could be a secondary attack location.
8. Evacuating folks will get in the way of police.
9. How will police distinguish friendlies from shooter if they get the gun away?
10. Counter Strategies are ridiculous

# IMPORTANT to NOTE:

- An active shooter/killer/violent intruder INTENDS TO KILL/HARM/DESTROY
- REAL TIME info will indicate what options can be used, USE those OPTIONS, use BEST JUDGEMENT
- Never REQUIRE a specific response from anyone, student or staff
- IF LOCKDOWN is the only immediate option— BARRICADE to buy time, then COUNTER, possibly EVACUATE
- WE HAVE A RIGHT TO DEFEND OURSELVES AND OUR STUDENTS!
- COMMIT to a decision made and MOVE!



# A.L.I.C.E. REVIEW

- **A**lert: all are authorized to announce 77#111— dial 911 or 9 911 from classroom phone, cell
- **L**ockdown: strong starting point, must barricade to buy time
- **I**nform: use real time info to decide response, continue giving info if possible
- **C**ounter: interrupt the skill set needed to shoot accurately, DISTRACT
- **E**vacuate: get away from danger if possible—

BEST PLACE TO BE IS OUT OF THE BUILDING